



SH4

TYPE 4 SAFETY LIGHT CURTAINS



- Complete type 4 safety light curtains line
- Finger (14 mm), hand (30 mm), or body protection
- Improved performance and features
- Compact profile (35 x 40 mm)
- Wide range scalable in Base, Standard and Advanced models
- Simultaneous muting and blanking
- Innovative wireless monitoring and configuration system
- Optical two beams synchronization and anti-interference coding
- Base functions: alignment, automatic restart
- Standard functions: manual restart, EDM
- Standard Muting functions: 2-signals mono and bidirectional muting, override
- Advanced functions: partial muting, dynamic partial muting, 4-signals muting, reduced resolution, multiple fixed or floating blanking zones
- Active/Passive version for body protection





CODE DESCRIPTION

SH 4 - 14 - 0300 - SM - AP - 8 - 5

| | | |
|------------------------------|-------------|--|
| series | SH | Safety light curtain |
| type | 4 | Type 4 |
| detection capability | 14 | Finger: 14 mm |
| | 30 | Hand: 30 mm |
| | 2 | Body: 2 Beams |
| | 3 | Body: 3 Beams |
| | 4 | Body: 4 Beams |
| monitored height | 0300 | 300 mm |
| | ... | |
| | 2250 | 2250 mm |
| functionality | B | Base |
| | S | Standard |
| | SM | Standard muting |
| | A | Advanced |
| | C | Cascade |
| optical structure | | Emitter and receiver |
| | AP | Active side and retroreflective passive side |
| receiver main connector | 5 | 5-pins male M12 |
| | 8 | 8-pins male M12 |
| | 12 | 12-pins male M12 |
| receiver secondary connector | | No connector |
| | 5 | 5-pin female M12 |

TECHNICAL FEATURES

| | SH4-14-****-**-*** | SH4-30-****-**-*** |
|--|---|--|
| Protection |  finger |  hand |
| Type (EN61496-1) | 4 | |
| PL (EN ISO 13849-1) | e | |
| SIL (IEC 61508) | 3 | |
| Optical structure | Emitter and Receiver | |
| Protected height | 300...2250 mm (with 150 mm steps) | |
| Detection capability | 14 mm | 30 mm |
| Operating range | 0.2 ... 10 m | 0.2 ... 20 m |
| Operating distance using muting arms (SG-F1/G1-ARMS and SG-F2/G2-ARMS) | 0.5 ... 7 m | |
| Operating distance using reflective muting arms (SH4-T-ARMS or SH4-L-ARMS) | 0.5 ... 3 m | |
| Dead Zone | No dead zone | |
| Cascade connection | Up to 3 units | |
| Power supply (Vdc) | 24 Vdc ± 20% | |
| Transmitter consumption | 3.5 W max | |
| Receiver consumption | 5.5 W max (without load) | |
| Safe Outputs | 2 OSSD, with short circuit protection | |
| Auxiliary Outputs | 2 PNP, with short circuit protection | |
| Output current | 250 mA max / each output, 500 mA max total outputs | |
| Capacitive load | 1 uF @ 24Vdc max | |
| Leakage current | < 1 mA | |
| Response time | from 12 to 30 ms (14 mm res) | from 10 to 19 ms (30 mm res) |
| Cables length | 30 m | |
| Electrical protection | Class III | |
| Light source | Infrared LED (850 nm wavelength) | |
| Effective aperture angle (EAA) | < ± 2.5° at 3 m | |
| Operating temperature | -30 ... +55 °C | |
| Storage temperature | -30 ... +70 °C | |
| Temperature class | T6 | |
| Humidity | 15 ... 95 % (no condensation) | |
| Mechanical protection | IP65, IP 67 (EN 60529) | |
| Vibrations resistance | 10 mm / 3 g, 5 ... 150 Hz frequency (EN 60068-2-6 / Class 3M7 IEC TR 60721-4-3) | |
| Shock resistance | 25 g x 6 ms x 600 (EN 60068-2-27 / Class 3M7 IEC TR 60721-4-3) | |
| Weight | 1.4 Kg/m (single bar, without package) | |
| Housing Material | Painted aluminium (yellow RAL 1003) | |
| Caps and covers material | PBT | |
| Window material | MAKROLON AR 7099 Clear PC | |
| Functions BASE models (SH4-*B-*) | Automatic Restart | |
| Functions STANDARD models (SH4-*S-*) | Manual / Automatic Restart, Reset, External Device Monitoring (EDM), Alignment mode | |
| Functions STANDARD MUTING models (SH4-*SM-*) | Manual / Automatic Restart, Reset, External Device Monitoring (EDM), Alignment mode, 2-signals T Muting / L Muting, Muting dependent Override, Partial muting (half protection height), Muting input filtering and timeout setting, Anti-interference coding | |
| Functions ADVANCED models (SH4-*A-*) | Manual / Automatic Restart, Reset, External Device Monitoring (EDM), Alignment mode, 2-signals T Muting / L Muting, Muting dependent Override, Partial muting (half protection height), Muting input filtering and timeout setting, Anti-interference coding, 4-signals Muting, Dynamic partial muting, Partial Muting (at beams level), Fixed Blanking, External signal fixed blanking teach-in, Floating Blanking, Reduced resolution, Integrated laser aimer | |
| Functions CASCADE models (SH4-*C-*) | Cascade models acquire the same functions of the main unit to which they are connected (STANDARD MUTING or ADVANCED) | |
| Configuration BASE models (SH4-*B-*) and STANDARD models (SH4-*S-*) | By Wiring | |
| Configuration STANDARD MUTING models (SH4-*SM-*) | By DIP-Switches | |
| Configuration ADVANCED models (SH4-*A-*) | By DATASENSING SH4 DESIGNER and wi-fi connection | |

| | SH4-2-0500-*-*-* | SH4-3-0800-*-*-* | SH4-4-****-*-*-* |
|--|--|------------------|------------------|
| |  | | |
| Protection | body | | |
| Type (EN61496-1) | 4 | | |
| PL (EN ISO 13849-1) | e | | |
| SIL (IEC 61508) | 3 | | |
| Optical structure | Emitter and Receiver | | |
| Protected height | 500 mm | 800 mm | 900 or 1200 mm |
| Detection capability | 500 mm | 400 mm | 300 or 400 mm |
| Operating range | Short range: 0.5 ... 15 m (default value); Long range: 5 ... 70 m (selectable) | | |
| Operating distance using muting arms (SG-F1/G1-ARMS and SG-F2/G2-ARMS) | 0.5 ... 7 m | | |
| Operating distance using reflective muting arms (SH4-T-ARMS or SH4-L-ARMS) | 0.5 ... 3 m | | |
| Dead Zone | 130 mm Distance from bottom to first beam | | |
| Cascade connection | Not possible | | |
| Power supply (Vdc) | 24 Vdc ± 20% | | |
| Transmitter consumption | 3.5 W max | | |
| Receiver consumption | 5.5 W max (without load) | | |
| Safe Outputs | 2 OSSD, with short circuit protection | | |
| Auxiliary Outputs | 2 PNP, with short circuit protection | | |
| Output current | 250 mA max / each output, 500 mA max total outputs | | |
| Capacitive load | 1 uF @ 24Vdc max | | |
| Leakage current | < 1 mA | | |
| Response time | from 12 to 15 ms | | |
| Cables length | 30 m receiver; 50 m transmitter | | |
| Electrical protection | Class III | | |
| Light source | Infrared LED (850 nm wavelength) | | |
| Effective aperture angle (EAA) | < ± 2.5° at 3 m | | |
| Operating temperature | -30 ... +55 °C | | |
| Storage temperature | -30 ... +70 °C | | |
| Temperature class | T6 | | |
| Humidity | 15 ... 95 % (no condensation) | | |
| Mechanical protection | IP65, IP 67 (EN 60529) | | |
| Vibrations resistance | 10 mm / 3 g, 5 ... 150 Hz frequency (EN 60068-2-6 / Class 3M7 IEC TR 60721-4-3) | | |
| Shock resistance | 25 g x 6 ms x 600 (EN 60068-2-27 / Class 3M7 IEC TR 60721-4-3) | | |
| Weight | 1.4 Kg/m (single bar, without package) | | |
| Housing Material | Painted aluminium (yellow RAL 1003) | | |
| Caps and covers material | PBT | | |
| Window material | MAKROLON AR 7099 Clear PC | | |
| Functions BASE models (SH4-* -B-*) | Automatic Restart | | |
| Functions STANDARD models (SH4-* -S-*) | Manual / Automatic Restart, Reset, External Device Monitoring (EDM), Alignment mode | | |
| Functions STANDARD MUTING models (SH4-* -SM-*) | Manual / Automatic Restart, Reset, External Device Monitoring (EDM), Alignment mode, 2-signals T Muting / L Muting, Muting dependent Override, Partial muting (half protection height), Muting input filtering and timeout setting, Anti-interference coding | | |
| Functions ADVANCED models (SH4-* -A-*) | Manual / Automatic Restart, Reset, External Device Monitoring (EDM), Alignment mode, 2-signals T Muting / L Muting, Muting dependent Override, Partial muting (half protection height), Muting input filtering and timeout setting, Anti-interference coding, 4-signals Muting, Dynamic partial muting, Partial Muting (at beams level), Fixed Blanking, External signal fixed blanking teach-in, Floating Blanking, Reduced resolution, Integrated red LED aimers for each beam | | |
| Configuration BASE models (SH4-* -B-*) and STANDARD models (SH4-* -S-*) | By Wiring | | |
| Configuration STANDARD MUTING models (SH4-* -SM-*) | By DIP-Switches | | |
| Configuration ADVANCED models (SH4-* -A-*) | By DATASENSING SH4 DESIGNER and wi-fi connection | | |

| | SH4-2-0500-*-AP-*** | SH4-3-0800-*-AP-*** | SH4-4-****-*-AP-*** |
|--|---|---------------------|--|
| |  | | |
| Protection | body | | |
| Type (EN61496-1) | 4 | | |
| PL (EN ISO 13849-1) | e | | |
| SIL (IEC 61508) | 3 | | |
| Optical structure | Active Side and Retroreflective Passive Side | | |
| Protected height | 500 mm | 800 mm | 900 or 1200 mm |
| Detection capability | 500 mm | 400 mm | 300 mm |
| Operating range | 0.5 ... 8 m | 0.5 ... 8 m | 0.5 ... 6.5 m (SH4-4-0900-AP-**-*) 0.5 ... 8 m (SH4-4-1200-AP-**-*) |
| Operating distance using reflective muting arms (SH4-T-ARMS or SH4-L-ARMS) | 0.5 ... 3 m | | |
| Dead Zone | 130 mm Distance from bottom to first beam | | |
| Cascade connection | Not possible | | |
| Power supply (Vdc) | 24 Vdc ± 20% | | |
| Active unit consumption | 2 W max (without load) | | |
| Safe Outputs | 2 OSSD, with short circuit protection | | |
| Auxiliary Outputs | 2 PNP, with short circuit protection | | |
| Output current | 250 mA max / each output, 500 mA max total outputs | | |
| Capacitive load | 1 uF @ 24Vdc max | | |
| Leakage current | < 1 mA | | |
| Response time | 15 ms | | |
| Cables length | 30 m | | |
| Electrical protection | Class III | | |
| Light source | Infrared LED (850 nm wavelength) | | |
| Effective aperture angle (EAA) | < ± 2.5° at 3 m | | |
| Operating temperature | -30 ...+55 °C | | |
| Storage temperature | -30 ...+70 °C | | |
| Temperature class | T6 | | |
| Humidity | 15 ... 95 % (no condensation) | | |
| Mechanical protection | IP65, IP 67 (EN 60529) | | |
| Vibrations resistance | 10 mm / 3 g, 5 ... 150 Hz frequency (EN 60068-2-6 / Class 3M7 IEC TR 60721-4-3) | | |
| Shock resistance | 25 g x 6 ms x 600 (EN 60068-2-27 / Class 3M7 IEC TR 60721-4-3) | | |
| Weight | 1.4 Kg/m (single bar, without package) | | |
| Housing Material | Painted aluminium (yellow RAL 1003) | | |
| Caps and covers material | PBT | | |
| Window material | MAKROLON AR 7099 Clear PC | | |
| Functions BASE models (SH4-*-B-*) | Automatic Restart | | |
| Functions STANDARD models (SH4-*-S-*) | Manual / Automatic Restart, Reset, External Device Monitoring (EDM), Alignment mode | | |
| Functions STANDARD MUTING models (SH4-*-SM-*) | Manual / Automatic Restart, Reset, External Device Monitoring (EDM), Alignment mode, 2-signals T Muting / L Muting, Muting dependent Override, Partial muting (half protection height), Muting input filtering and timeout setting, Anti-interference coding | | |
| Functions ADVANCED models (SH4-*-A-*) | Manual / Automatic Restart, Reset, External Device Monitoring (EDM), Alignment mode, 2-signals T Muting / L Muting, Muting dependent Override, Partial muting (half protection height), Muting input filtering and timeout setting, Anti-interference coding, 4-signals Muting, Dynamic partial muting, Partial Muting (at beams level), Fixed Blanking | | |
| Configuration BASIC models (SH4-*-B-*) and STANDARD models (SH4-*-S-*) | By Wiring | | |
| Configuration STANDARD MUTING models (SH4-*-SM-*) | By DIP-Switches | | |
| Configuration ADVANCED models (SH4-*-A-*) | By DATASENSING SH4 DESIGNER and wi-fi connection | | |

AVAILABLE MODELS

| Capability | Range | Functionality | Receiver connector | Protected height (mm) | Beams | Response time (ms) with Anti-Interference code disabled | Model |
|------------|-------------|---------------|---------------------------------------|-----------------------|-------|---|---------------------------------------|
| 14 mm | 0.2... 10 m | basic | 5 poles | 300 | 30 | 9 | SH4-14-0300-B-5 (957920001) |
| | | | | 450 | 45 | 10 | SH4-14-0450-B-5 (957920002) |
| | | | | 600 | 60 | 12 | SH4-14-0600-B-5 (957920003) |
| | | | | 750 | 75 | 13 | SH4-14-0750-B-5 (957920004) |
| | | | | 900 | 90 | 15 | SH4-14-0900-B-5 (957920005) |
| | | | | 1050 | 105 | 16 | SH4-14-1050-B-5 (957920006) |
| | | | | 1200 | 120 | 18 | SH4-14-1200-B-5 (957920007) |
| | | | | 1350 | 135 | 20 | SH4-14-1350-B-5 (957920008) |
| | | | | 1500 | 150 | 21 | SH4-14-1500-B-5 (957920009) |
| | | | | 1650 | 165 | 23 | SH4-14-1650-B-5 (957920010) |
| | | | | 1800 | 180 | 24 | SH4-14-1800-B-5 (957920011) |
| | | | | 1950 | 195 | 26 | SH4-14-1950-B-5 (957920012) |
| | | | | 2100 | 210 | 27 | SH4-14-2100-B-5 (957920013) |
| 2250 | 225 | 29 | SH4-14-2250-B-5 (957920014) | | | | |
| 14 mm | 0.2... 10 m | standard | 8 poles | 300 | 30 | 9 | SH4-14-0300-S-8 (957920015) |
| | | | | 450 | 45 | 10 | SH4-14-0450-S-8 (957920016) |
| | | | | 600 | 60 | 12 | SH4-14-0600-S-8 (957920017) |
| | | | | 750 | 75 | 13 | SH4-14-0750-S-8 (957920018) |
| | | | | 900 | 90 | 15 | SH4-14-0900-S-8 (957920019) |
| | | | | 1050 | 105 | 16 | SH4-14-1050-S-8 (957920020) |
| | | | | 1200 | 120 | 18 | SH4-14-1200-S-8 (957920021) |
| | | | | 1350 | 135 | 20 | SH4-14-1350-S-8 (957920022) |
| | | | | 1500 | 150 | 21 | SH4-14-1500-S-8 (957920023) |
| | | | | 1650 | 165 | 23 | SH4-14-1650-S-8 (957920024) |
| | | | | 1800 | 180 | 24 | SH4-14-1800-S-8 (957920025) |
| | | | | 1950 | 195 | 26 | SH4-14-1950-S-8 (957920026) |
| | | | | 2100 | 210 | 27 | SH4-14-2100-S-8 (957920027) |
| 2250 | 225 | 29 | SH4-14-2250-S-8 (957920028) | | | | |

For units in cascade, the overall response time is given by this formula. 2 units: (sum of units response time + 1 ms); 3 units: (sum of units response time - 1 ms)

| Capability | Range | Functionality | Receiver connector | Protected height (mm) | Beams | Response time (ms) with Anti-Interference code disabled | Response time (ms) with Anti-Interference code enabled | Model |
|------------|-------------|-----------------|--------------------|-----------------------|-------|---|--|--|
| 14 mm | 0.2... 10 m | standard muting | 8 poles | 300 | 30 | 9 | 14 | SH4-14-0300-SM-8 (957920043) |
| | | | | 450 | 45 | 10 | 18 | SH4-14-0450-SM-8 (957920044) |
| | | | | 600 | 60 | 12 | 22 | SH4-14-0600-SM-8 (957920045) |
| | | | | 750 | 75 | 13 | 26 | SH4-14-0750-SM-8 (957920046) |
| | | | | 900 | 90 | 15 | 30 | SH4-14-0900-SM-8 (957920047) |
| | | | | 1050 | 105 | 16 | 33 | SH4-14-1050-SM-8 (957920048) |
| | | | | 1200 | 120 | 18 | 37 | SH4-14-1200-SM-8 (957920049) |
| | | | | 1350 | 135 | 20 | 41 | SH4-14-1350-SM-8 (957920050) |
| | | | | 1500 | 150 | 21 | 45 | SH4-14-1500-SM-8 (957920051) |
| | | | | 1650 | 165 | 23 | 49 | SH4-14-1650-SM-8 (957920052) |
| | | | | 1800 | 180 | 24 | 52 | SH4-14-1800-SM-8 (957920053) |
| | | | | 1950 | 195 | 26 | 56 | SH4-14-1950-SM-8 (957920054) |
| | | | | 2100 | 210 | 27 | 60 | SH4-14-2100-SM-8 (957920055) |
| | | | | 2250 | 225 | 29 | 64 | SH4-14-2250-SM-8 (957920056) |
| 14 mm | 0.2... 10 m | standard muting | 8 and 5 poles | 300 | 30 | 9 | 14 | SH4-14-0300-SM-8-5 (957920565) |
| | | | | 450 | 45 | 10 | 18 | SH4-14-0450-SM-8-5 (957920566) |
| | | | | 600 | 60 | 12 | 22 | SH4-14-0600-SM-8-5 (957920567) |
| | | | | 750 | 75 | 13 | 26 | SH4-14-0750-SM-8-5 (957920568) |
| | | | | 900 | 90 | 15 | 30 | SH4-14-0900-SM-8-5 (957920569) |
| | | | | 1050 | 105 | 16 | 33 | SH4-14-1050-SM-8-5 (957920570) |
| | | | | 1200 | 120 | 18 | 37 | SH4-14-1200-SM-8-5 (957920571) |
| | | | | 1350 | 135 | 20 | 41 | SH4-14-1350-SM-8-5 (957920572) |
| | | | | 1500 | 150 | 21 | 45 | SH4-14-1500-SM-8-5 (957920573) |
| | | | | 1650 | 165 | 23 | 49 | SH4-14-1650-SM-8-5 (957920574) |
| | | | | 1800 | 180 | 24 | 52 | SH4-14-1800-SM-8-5 (957920575) |
| | | | | 1950 | 195 | 26 | 56 | SH4-14-1950-SM-8-5 (957920576) |
| | | | | 2100 | 210 | 27 | 60 | SH4-14-2100-SM-8-5 (957920577) |
| | | | | 2250 | 225 | 29 | 64 | SH4-14-2250-SM-8-5 (957920578) |

For units in cascade, the overall response time is given by this formula. 2 units: (sum of units response time + 1 ms); 3 units: (sum of units response time - 1 ms)

| Capability | Range | Functionality | Receiver connector | Protected height (mm) | Beams | Response time (ms) with Anti-Interference code disabled | Response time (ms) with Anti-Interference code enabled | Model |
|------------|--------------|---------------|--------------------|-----------------------|-------|---|--|--|
| 14 mm | 0.2 ... 10 m | advanced | 12 poles | 300 | 30 | 9 | 14 | SH4-14-0300-A-12 (957920147) |
| | | | | 450 | 45 | 10 | 18 | SH4-14-0450-A-12 (957920148) |
| | | | | 600 | 60 | 12 | 22 | SH4-14-0600-A-12 (957920149) |
| | | | | 750 | 75 | 13 | 26 | SH4-14-0750-A-12 (957920150) |
| | | | | 900 | 90 | 15 | 30 | SH4-14-0900-A-12 (957920151) |
| | | | | 1050 | 105 | 16 | 33 | SH4-14-1050-A-12 (957920152) |
| | | | | 1200 | 120 | 18 | 37 | SH4-14-1200-A-12 (957920153) |
| | | | | 1350 | 135 | 20 | 41 | SH4-14-1350-A-12 (957920154) |
| | | | | 1500 | 150 | 21 | 45 | SH4-14-1500-A-12 (957920155) |
| | | | | 1650 | 165 | 23 | 49 | SH4-14-1650-A-12 (957920156) |
| | | | | 1800 | 180 | 24 | 52 | SH4-14-1800-A-12 (957920157) |
| | | | | 1950 | 195 | 26 | 56 | SH4-14-1950-A-12 (957920158) |
| | | | | 2100 | 210 | 27 | 60 | SH4-14-2100-A-12 (957920159) |
| | | | | 2250 | 225 | 29 | 64 | SH4-14-2250-A-12 (957920160) |
| 14 mm | 0.2 ... 10 m | advanced | 12 and 5 poles | 300 | 30 | 9 | 14 | SH4-14-0300-A-12-5 (957920161) |
| | | | | 450 | 45 | 10 | 18 | SH4-14-0450-A-12-5 (957920162) |
| | | | | 600 | 60 | 12 | 22 | SH4-14-0600-A-12-5 (957920163) |
| | | | | 750 | 75 | 13 | 26 | SH4-14-0750-A-12-5 (957920164) |
| | | | | 900 | 90 | 15 | 30 | SH4-14-0900-A-12-5 (957920165) |
| | | | | 1050 | 105 | 16 | 33 | SH4-14-1050-A-12-5 (957920166) |
| | | | | 1200 | 120 | 18 | 37 | SH4-14-1200-A-12-5 (957920167) |
| | | | | 1350 | 135 | 20 | 41 | SH4-14-1350-A-12-5 (957920168) |
| | | | | 1500 | 150 | 21 | 45 | SH4-14-1500-A-12-5 (957920169) |
| | | | | 1650 | 165 | 23 | 49 | SH4-14-1650-A-12-5 (957920170) |
| | | | | 1800 | 180 | 24 | 52 | SH4-14-1800-A-12-5 (957920171) |
| | | | | 1950 | 195 | 26 | 56 | SH4-14-1950-A-12-5 (957920172) |
| | | | | 2100 | 210 | 27 | 60 | SH4-14-2100-A-12-5 (957920173) |
| | | | | 2250 | 225 | 29 | 64 | SH4-14-2250-A-12-5 (957920174) |

For units in cascade, the overall response time is given by this formula. 2 units: (sum of units response time + 1 ms); 3 units: (sum of units response time - 1 ms)

| Capability | Range | Functionality | Receiver connector | Protected height (mm) | Beams | Response time (ms) with Anti-Interference code disabled | Response time (ms) with Anti-Interference code enabled | Model |
|------------|--------------|---------------|--------------------|-----------------------|-------|---|--|---|
| 14 mm | 0.2 ... 10 m | cascade | 5 and 5 poles | 300 | 30 | 9 | 14 | SH4-14-0300-C-5-5 (957920029) |
| | | | | 450 | 45 | 10 | 18 | SH4-14-0450-C-5-5 (957920030) |
| | | | | 600 | 60 | 12 | 22 | SH4-14-0600-C-5-5 (957920031) |
| | | | | 750 | 75 | 13 | 26 | SH4-14-0750-C-5-5 (957920032) |
| | | | | 900 | 90 | 15 | 30 | SH4-14-0900-C-5-5 (957920033) |
| | | | | 1050 | 105 | 16 | 33 | SH4-14-1050-C-5-5 (957920034) |
| | | | | 1200 | 120 | 18 | 37 | SH4-14-1200-C-5-5 (957920035) |
| | | | | 1350 | 135 | 20 | 41 | SH4-14-1350-C-5-5 (957920036) |
| | | | | 1500 | 150 | 21 | 45 | SH4-14-1500-C-5-5 (957920037) |
| | | | | 1650 | 165 | 23 | 49 | SH4-14-1650-C-5-5 (957920038) |
| | | | | 1800 | 180 | 24 | 52 | SH4-14-1800-C-5-5 (957920039) |
| | | | | 1950 | 195 | 26 | 56 | SH4-14-1950-C-5-5 (957920040) |
| | | | | 2100 | 210 | 27 | 60 | SH4-14-2100-C-5-5 (957920041) |
| | | | | 2250 | 225 | 29 | 64 | SH4-14-2250-C-5-5 (957920042) |
| 30 mm | 0.2 ... 20 m | base | 5 poles | 300 | 12 | 7 | - | SH4-30-0300-B-5 (957920057) |
| | | | | 450 | 18 | 8 | - | SH4-30-0450-B-5 (957920058) |
| | | | | 600 | 24 | 9 | - | SH4-30-0600-B-5 (957920059) |
| | | | | 750 | 30 | 9 | - | SH4-30-0750-B-5 (957920060) |
| | | | | 900 | 36 | 10 | - | SH4-30-0900-B-5 (957920061) |
| | | | | 1050 | 42 | 11 | - | SH4-30-1050-B-5 (957920062) |
| | | | | 1200 | 48 | 12 | - | SH4-30-1200-B-5 (957920063) |
| | | | | 1350 | 54 | 12 | - | SH4-30-1350-B-5 (957920064) |
| | | | | 1500 | 60 | 13 | - | SH4-30-1500-B-5 (957920065) |
| | | | | 1650 | 66 | 14 | - | SH4-30-1650-B-5 (957920066) |
| | | | | 1800 | 72 | 14 | - | SH4-30-1800-B-5 (957920067) |
| | | | | 1950 | 78 | 15 | - | SH4-30-1950-B-5 (957920068) |
| | | | | 2100 | 84 | 16 | - | SH4-30-2100-B-5 (957920069) |
| | | | | 2250 | 90 | 17 | - | SH4-30-2250-B-5 (957920070) |

For units in cascade, the overall response time is given by this formula. 2 units: (sum of units response time + 1 ms); 3 units: (sum of units response time - 1 ms)

| Capability | Range | Functionality | Receiver connector | Protected height (mm) | Beams | Response time (ms) with Anti-Interference code disabled | Response time (ms) with Anti-Interference code enabled | Model |
|------------|--------------|-----------------|--------------------|-----------------------|-------|---|--|--|
| 30 mm | 0.2 ... 20 m | standard | 8 poles | 300 | 12 | 7 | - | SH4-30-0300-S-8 (957920071) |
| | | | | 450 | 18 | 8 | - | SH4-30-0450-S-8 (957920072) |
| | | | | 600 | 24 | 9 | - | SH4-30-0600-S-8 (957920073) |
| | | | | 750 | 30 | 9 | - | SH4-30-0750-S-8 (957920074) |
| | | | | 900 | 36 | 10 | - | SH4-30-0900-S-8 (957920075) |
| | | | | 1050 | 42 | 11 | - | SH4-30-1050-S-8 (957920076) |
| | | | | 1200 | 48 | 12 | - | SH4-30-1200-S-8 (957920077) |
| | | | | 1350 | 54 | 12 | - | SH4-30-1350-S-8 (957920078) |
| | | | | 1500 | 60 | 13 | - | SH4-30-1500-S-8 (957920079) |
| | | | | 1650 | 66 | 14 | - | SH4-30-1650-S-8 (957920080) |
| | | | | 1800 | 72 | 14 | - | SH4-30-1800-S-8 (957920081) |
| | | | | 1950 | 78 | 15 | - | SH4-30-1950-S-8 (957920082) |
| | | | | 2100 | 84 | 16 | - | SH4-30-2100-S-8 (957920083) |
| | | | | 2250 | 90 | 17 | - | SH4-30-2250-S-8 (957920084) |
| 30 mm | 0.2 ... 20 m | standard muting | 8 poles | 300 | 12 | 7 | 10 | SH4-30-0300-SM-8 (957920099) |
| | | | | 450 | 18 | 8 | 12 | SH4-30-0450-SM-8 (957920100) |
| | | | | 600 | 24 | 9 | 13 | SH4-30-0600-SM-8 (957920101) |
| | | | | 750 | 30 | 9 | 15 | SH4-30-0750-SM-8 (957920102) |
| | | | | 900 | 36 | 10 | 17 | SH4-30-0900-SM-8 (957920103) |
| | | | | 1050 | 42 | 11 | 18 | SH4-30-1050-SM-8 (957920104) |
| | | | | 1200 | 48 | 12 | 20 | SH4-30-1200-SM-8 (957920105) |
| | | | | 1350 | 54 | 12 | 22 | SH4-30-1350-SM-8 (957920106) |
| | | | | 1500 | 60 | 13 | 23 | SH4-30-1500-SM-8 (957920107) |
| | | | | 1650 | 66 | 14 | 25 | SH4-30-1650-SM-8 (957920108) |
| | | | | 1800 | 72 | 14 | 27 | SH4-30-1800-SM-8 (957920109) |
| | | | | 1950 | 78 | 15 | 28 | SH4-30-1950-SM-8 (957920110) |
| | | | | 2100 | 84 | 16 | 30 | SH4-30-2100-SM-8 (957920111) |
| | | | | 2250 | 90 | 17 | 32 | SH4-30-2250-SM-8 (957920112) |

For units in cascade, the overall response time is given by this formula. 2 units: (sum of units response time + 1 ms); 3 units: (sum of units response time - 1 ms)

| Capability | Range | Functionality | Receiver connector | Protected height (mm) | Beams | Response time (ms) with Anti-Interference code disabled | Response time (ms) with Anti-Interference code enabled | Model |
|------------|--------------|-----------------|--------------------|-----------------------|-------|---|--|--|
| 30 mm | 0.2 ... 20 m | standard muting | 8 and 5 poles | 300 | 12 | 7 | 10 | SH4-30-0300-SM-8-5 (957920085) |
| | | | | 450 | 18 | 8 | 12 | SH4-30-0450-SM-8-5 (957920086) |
| | | | | 600 | 24 | 9 | 13 | SH4-30-0600-SM-8-5 (957920087) |
| | | | | 750 | 30 | 9 | 15 | SH4-30-0750-SM-8-5 (957920088) |
| | | | | 900 | 36 | 10 | 17 | SH4-30-0900-SM-8-5 (957920089) |
| | | | | 1050 | 42 | 11 | 18 | SH4-30-1050-SM-8-5 (957920090) |
| | | | | 1200 | 48 | 12 | 20 | SH4-30-1200-SM-8-5 (957920091) |
| | | | | 1350 | 54 | 12 | 22 | SH4-30-1350-SM-8-5 (957920092) |
| | | | | 1500 | 60 | 13 | 23 | SH4-30-1500-SM-8-5 (957920093) |
| | | | | 1650 | 66 | 14 | 25 | SH4-30-1650-SM-8-5 (957920094) |
| | | | | 1800 | 72 | 14 | 27 | SH4-30-1800-SM-8-5 (957920095) |
| | | | | 1950 | 78 | 15 | 28 | SH4-30-1950-SM-8-5 (957920096) |
| | | | | 2100 | 84 | 16 | 30 | SH4-30-2100-SM-8-5 (957920097) |
| | | | | 2250 | 90 | 17 | 32 | SH4-30-2250-SM-8-5 (957920098) |
| 30 mm | 0.2 ... 20 m | advanced | 12 poles | 300 | 12 | 7 | 10 | SH4-30-0300-A-12 (957920189) |
| | | | | 450 | 18 | 8 | 12 | SH4-30-0450-A-12 (957920190) |
| | | | | 600 | 24 | 9 | 13 | SH4-30-0600-A-12 (957920191) |
| | | | | 750 | 30 | 9 | 15 | SH4-30-0750-A-12 (957920192) |
| | | | | 900 | 36 | 10 | 17 | SH4-30-0900-A-12 (957920193) |
| | | | | 1050 | 42 | 11 | 18 | SH4-30-1050-A-12 (957920194) |
| | | | | 1200 | 48 | 12 | 20 | SH4-30-1200-A-12 (957920195) |
| | | | | 1350 | 54 | 12 | 22 | SH4-30-1350-A-12 (957920196) |
| | | | | 1500 | 60 | 13 | 23 | SH4-30-1500-A-12 (957920197) |
| | | | | 1650 | 66 | 14 | 25 | SH4-30-1650-A-12 (957920198) |
| | | | | 1800 | 72 | 14 | 27 | SH4-30-1800-A-12 (957920199) |
| | | | | 1950 | 78 | 15 | 28 | SH4-30-1950-A-12 (957920200) |
| | | | | 2100 | 84 | 16 | 30 | SH4-30-2100-A-12 (957920201) |
| | | | | 2250 | 90 | 17 | 32 | SH4-30-2250-A-12 (957920202) |

For units in cascade, the overall response time is given by this formula. 2 units: (sum of units response time + 1 ms); 3 units: (sum of units response time - 1 ms)

| Capability | Range | Functionality | Receiver connector | Protected height (mm) | Beams | Response time (ms) with Anti-Interference code disabled | Response time (ms) with Anti-Interference code enabled | Model |
|------------|--------------|---------------|--------------------|-----------------------|-------|---|--|--|
| 30 mm | 0.2 ... 20 m | advanced | 5 and 12 poles | 300 | 12 | 7 | 10 | SH4-30-0300-A-12-5 (957920203) |
| | | | | 450 | 18 | 8 | 12 | SH4-30-0450-A-12-5 (957920204) |
| | | | | 600 | 24 | 9 | 13 | SH4-30-0600-A-12-5 (957920205) |
| | | | | 750 | 30 | 9 | 15 | SH4-30-0750-A-12-5 (957920206) |
| | | | | 900 | 36 | 10 | 17 | SH4-30-0900-A-12-5 (957920207) |
| | | | | 1050 | 42 | 11 | 18 | SH4-30-1050-A-12-5 (957920208) |
| | | | | 1200 | 48 | 12 | 20 | SH4-30-1200-A-12-5 (957920209) |
| | | | | 1350 | 54 | 12 | 22 | SH4-30-1350-A-12-5 (957920210) |
| | | | | 1500 | 60 | 13 | 23 | SH4-30-1500-A-12-5 (957920211) |
| | | | | 1650 | 66 | 14 | 25 | SH4-30-1650-A-12-5 (957920212) |
| | | | | 1800 | 72 | 14 | 27 | SH4-30-1800-A-12-5 (957920213) |
| | | | | 1950 | 78 | 15 | 28 | SH4-30-1950-A-12-5 (957920214) |
| | | | | 2100 | 84 | 16 | 30 | SH4-30-2100-A-12-5 (957920215) |
| | | | | 2250 | 90 | 17 | 32 | SH4-30-2250-A-12-5 (957920216) |
| 30 mm | 0.2 ... 20 m | cascade | 5 and 5 poles | 300 | 12 | 7 | 10 | SH4-30-0300-C-5-5 (957920113) |
| | | | | 450 | 18 | 8 | 12 | SH4-30-0450-C-5-5 (957920114) |
| | | | | 600 | 24 | 9 | 13 | SH4-30-0600-C-5-5 (957920115) |
| | | | | 750 | 30 | 9 | 15 | SH4-30-0750-C-5-5 (957920116) |
| | | | | 900 | 36 | 10 | 17 | SH4-30-0900-C-5-5 (957920117) |
| | | | | 1050 | 42 | 11 | 18 | SH4-30-1050-C-5-5 (957920118) |
| | | | | 1200 | 48 | 12 | 20 | SH4-30-1200-C-5-5 (957920119) |
| | | | | 1350 | 54 | 12 | 22 | SH4-30-1350-C-5-5 (957920120) |
| | | | | 1500 | 60 | 13 | 23 | SH4-30-1500-C-5-5 (957920121) |
| | | | | 1650 | 66 | 14 | 25 | SH4-30-1650-C-5-5 (957920122) |
| | | | | 1800 | 72 | 14 | 27 | SH4-30-1800-C-5-5 (957920123) |
| | | | | 1950 | 78 | 15 | 28 | SH4-30-1950-C-5-5 (957920124) |
| | | | | 2100 | 84 | 16 | 30 | SH4-30-2100-C-5-5 (957920125) |
| | | | | 2250 | 90 | 17 | 32 | SH4-30-2250-C-5-5 (957920126) |

For units in cascade, the overall response time is given by this formula. 2 units: (sum of units response time + 1 ms); 3 units: (sum of units response time - 1 ms)







| Capability | Range | Functionality | Receiver connector | Protected height (mm) | Beams | Response time (ms) with Anti-Interference code disabled | Response time (ms) with Anti-Interference code enabled | Model |
|----------------|--------------|-----------------|--------------------|-----------------------|-------|---|--|---|
| body detection | 0.5 ... 70 m | base | 5 poles | 500 | 2 | 12 | - | SH4-2-0500-B-5 (957920127) |
| | | | | 800 | 3 | 15 | - | SH4-3-0800-B-5 (957920128) |
| | | | | 900 | 4 | 15 | - | SH4-4-0900-B-5 (957920129) |
| | | | | 1200 | 4 | 15 | - | SH4-4-1200-B-5 (957920130) |
| | | standard | 8 poles | 500 | 2 | 12 | - | SH4-2-0500-S-8 (957920131) |
| | | | | 800 | 3 | 15 | - | SH4-3-0800-S-8 (957920132) |
| | | | | 900 | 4 | 15 | - | SH4-4-0900-S-8 (957920133) |
| | | | | 1200 | 4 | 15 | - | SH4-4-1200-S-8 (957920134) |
| | | standard muting | 8 poles | 500 | 2 | 12 | 23 | SH4-2-0500-SM-8 (957920139) |
| | | | | 800 | 3 | 15 | 27 | SH4-3-0800-SM-8 (957920140) |
| | | | | 900 | 4 | 15 | 29 | SH4-4-0900-SM-8 (957920141) |
| | | | | 1200 | 4 | 15 | 29 | SH4-4-1200-SM-8 (957920142) |
| | | standard muting | 8 and 5 poles | 500 | 2 | 12 | 23 | SH4-2-0500-SM-8-5 (957920135) |
| | | | | 800 | 3 | 15 | 27 | SH4-3-0800-SM-8-5 (957920136) |
| | | | | 900 | 4 | 15 | 29 | SH4-4-0900-SM-8-5 (957920137) |
| | | | | 1200 | 4 | 15 | 29 | SH4-4-1200-SM-8-5 (957920138) |
| | | advanced | 12 and 5 poles | 500 | 2 | 12 | 23 | SH4-2-0500-A-12-5 (957920231) |
| | | | | 800 | 3 | 15 | 27 | SH4-3-0800-A-12-5 (957920232) |
| | | | | 900 | 4 | 15 | 29 | SH4-4-0900-A-12-5 (957920233) |
| | | | | 1200 | 4 | 15 | 29 | SH4-4-1200-A-12-5 (957920234) |

For units in cascade, the overall response time is given by this formula. 2 units: (sum of units response time + 1 ms); 3 units: (sum of units response time - 1 ms)

| Capability | Range | Functionality | Receiver connector | Protected height (mm) | Beams | Response time (ms) with Anti-Interference code disabled | Response time (ms) with Anti-Interference code enabled | Model |
|----------------|-------------|-----------------|--------------------|-----------------------|-------|---|--|--|
| body detection | 0.5 ... 8 m | basic | 5 poles | 500 | 2 | 15 | - | SH4-2-0500-B-AP-5 (957920143) |
| | 0.5 ... 6.5 | | | 800 | 4 | 15 | - | SH4-3-0800-B-AP-5 (957920144) |
| | 0.5 ... 8 m | | | 900 | 4 | 15 | - | SH4-4-0900-B-AP-5 (957920145) |
| | 0.5 ... 8 m | | | 1200 | 4 | 15 | - | SH4-4-1200-B-AP-5 (957920146) |
| | 0.5 ... 8 m | standard muting | 8 poles | 500 | 2 | 15 | - | SH4-2-0500-SM-AP-8 (957920561) |
| | 0.5 ... 6.5 | | | 800 | 4 | 15 | - | SH4-3-0800-SM-AP-8 (957920562) |
| | 0.5 ... 8 m | | | 900 | 4 | 15 | - | SH4-4-0900-SM-AP-8 (957920563) |
| | 0.5 ... 8 m | | | 1200 | 4 | 15 | - | SH4-4-1200-SM-AP-8 (957920564) |
| | 0.5 ... 8 m | advanced | 12 and 5 poles | 500 | 2 | 15 | - | SH4-2-0500-A-AP-12-5 (957920239) |
| | 0.5 ... 6.5 | | | 800 | 4 | 15 | - | SH4-3-0800-A-AP-12-5 (957920240) |
| | 0.5 ... 8 m | | | 900 | 4 | 15 | - | SH4-4-0900-A-AP-12-5 (957920241) |
| | 0.5 ... 8 m | | | 1200 | 4 | 15 | - | SH4-4-1200-A-AP-12-5 (957920242) |

For units in cascade, the overall response time is given by this formula. 2 units: (sum of units response time + 1 ms); 3 units: (sum of units response time - 1 ms)

CONNECTION DIAGRAMS (RECEIVER MAIN CONNECTOR)

| SH4 BASE (SH4-**-****-B(-AP)-5): M12 male 5-poles | | SH4 STANDARD (SH4-**-****-S-8): M12 male 8-poles | |
|--|--|--|--|
|  <ul style="list-style-type: none"> 1 — BROWN — 24 Vdc — POWER 2 — WHITE — OSSD1 — SAFE OUTPUT 3 — BLUE — 0 Vdc — POWER 4 — BLACK — OSSD2 — SAFE OUTPUT 5 — GREY — COM — COM | |  <ul style="list-style-type: none"> 1 — WHITE — RESTART/RESET — INPUT 2 — BROWN — 24Vdc — POWER 3 — GREEN — EDM / SELECTION — INPUT 4 — YELLOW — EDM — INPUT 5 — GREY — OSSD1 — SAFE OUTPUT 6 — PINK — OSSD2 — SAFE OUTPUT 7 — BLUE — 0 Vdc — POWER 8 — RED — MAN/AUTO SELECTION — INPUT | |
| SH4 ST. MUTING (SH4-**-****-SM(-AP)-8): M12 male 8-poles | | SH4 STAND. MUTING (SH4-**-****-A(-AP)-12-5): M12 male 8-poles | |
|  <ul style="list-style-type: none"> 1 — WHITE — RESTART/RESET/EDM/OVERRIDE — INPUT 2 — BROWN — 24Vdc — POWER 3 — GREEN — MUTING1 — INPUT 4 — YELLOW — MUTING2 — INPUT 5 — GREY — OSSD1 — SAFE OUTPUT 6 — PINK — OSSD2 — SAFE OUTPUT 7 — BLUE — 0 Vdc — POWER 8 — RED — MUTING LAMP — OUTPUT | |  <ul style="list-style-type: none"> 1 — WHITE — RESTART/RESET — INPUT 2 — BROWN — 24Vdc — POWER 3 — GREEN — EDM / SELECTION — INPUT 4 — YELLOW — EDM — INPUT 5 — GREY — OSSD1 — SAFE OUTPUT 6 — PINK — OSSD2 — SAFE OUTPUT 7 — BLUE — 0 Vdc — POWER 8 — RED — OVER-RIDE 2 — INPUT | |
| SH4 ADVANCED (SH4-**-****-A-12): M12 male 12-poles | | SH4 ADVANCED (SH4-**-****-A(-AP)-12-5): M12 male 12-poles | |
|  <ul style="list-style-type: none"> 1 — BROWN — 24 Vdc — POWER 2 — BLUE — 0 Vdc — POWER 3 — WHITE — CONFIGURABLE INPUT — INPUT 4 — GREEN — CONFIGURABLE INPUT — INPUT 5 — PINK — OSSD2 — SAFE OUTPUT 6 — YELLOW — CONFIGURABLE INPUT — INPUT 7 — BLACK — CONFIGURABLE INPUT/OUTPUT — INPUT/OUTPUT 8 — GREY — OSSD1 — SAFE OUTPUT 9 — RED — CONFIGURABLE INPUT — INPUT 10 — VIOLET — CONFIGURABLE INPUT/OUTPUT — INPUT/OUTPUT 11 — GREY/PINK — OVER-RIDE 2 — OUTPUT 12 — RED/BLUE — CONFIGURABLE INPUT — INPUT | |  <ul style="list-style-type: none"> 1 — BROWN — 24 Vdc — POWER 2 — BLUE — 0 Vdc — POWER 3 — WHITE — CONFIGURABLE INPUT — INPUT 4 — GREEN — CONFIGURABLE INPUT — INPUT 5 — PINK — OSSD2 — SAFE OUTPUT 6 — YELLOW — CONFIGURABLE INPUT — INPUT 7 — BLACK — CONFIGURABLE INPUT — INPUT 8 — GREY — OSSD1 — SAFE OUTPUT 9 — RED — OVER-RIDE 2 — INPUT 10 — VIOLET — CONFIGURABLE INPUT/OUTPUT — INPUT/OUTPUT 11 — GREY/PINK — CONFIGURABLE INPUT/OUTPUT — INPUT/OUTPUT 12 — RED/BLUE — N/A — N/A | |

NOTES:

Inputs and Outputs of SH4 ADVANCED can be reconfigured with DATASENSING SH4 DESIGNER APP between the following:

| INPUTS | | | | OUTPUTS |
|-----------|-----------|-----------------|------------------|-------------------|
| • Reset | • EDM | • Muting3 | • Override1 | • Lamp |
| • Restart | • Muting1 | • Muting4 | • Teach in | • Override status |
| • Align | • Muting2 | • Muting Enable | • Beam Tolerance | |

CONNECTION DIAGRAMS (RECEIVER SECONDARY CONNECTOR)

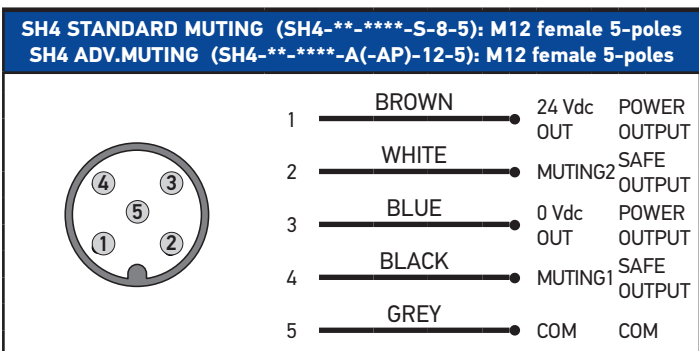

CONNECTION DIAGRAMS (TRANSMITTER MAIN CONNECTOR)

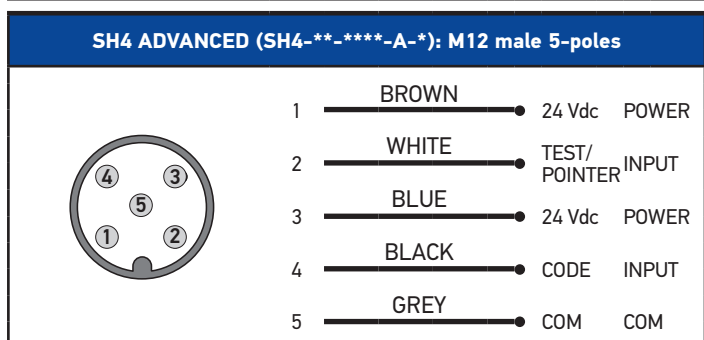
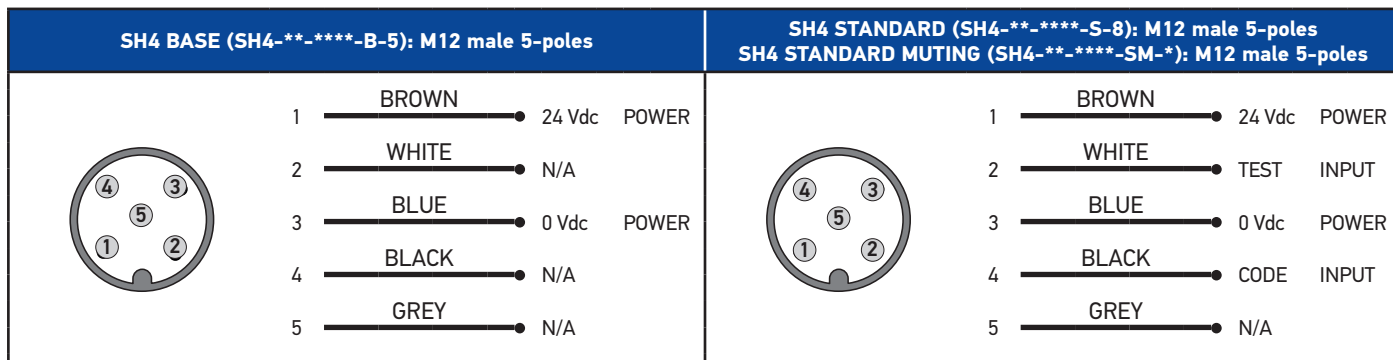

CONNECTION DIAGRAMS (TRANSMITTER SECONDARY CONNECTOR)

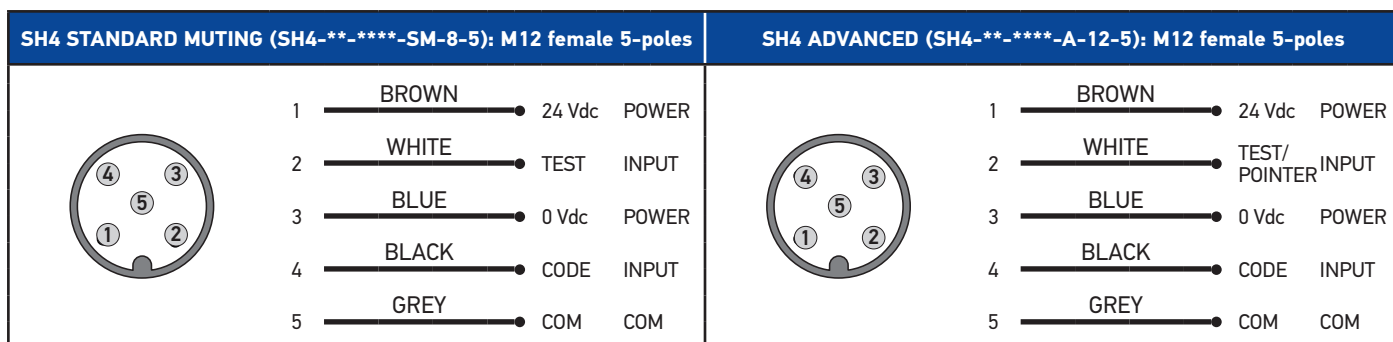

NOTE: PIN2 on transmitter main connector of body resolution models (SH4-2/3/4-*-**) can be used for selection of short or long range.

DIMENSIONS (FINGER)

SH4-14-***-**-**_*

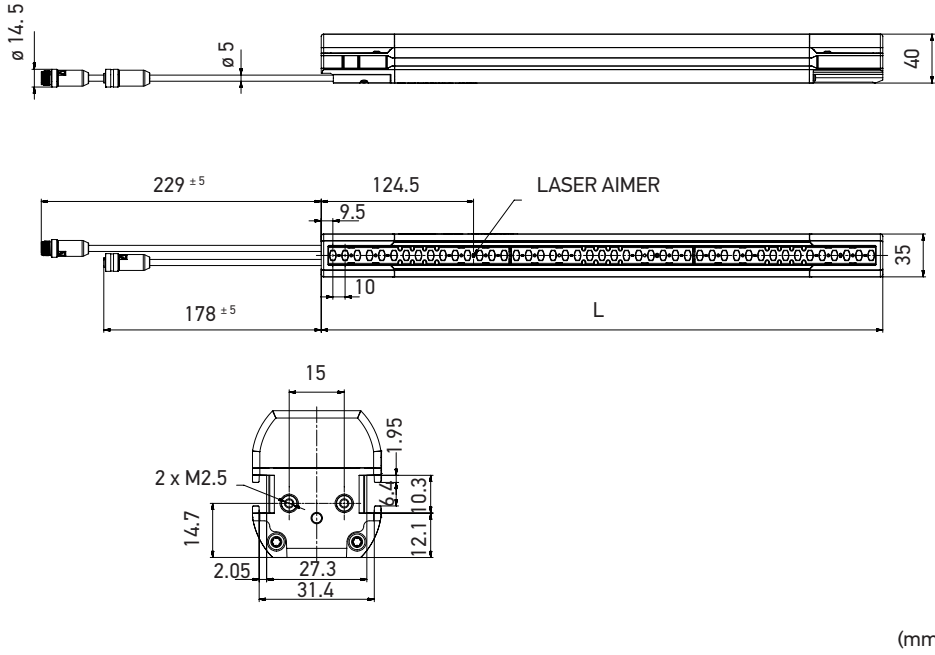

| Model | L (mm) |
|-------------------|--------|
| SH4-14-0300-***_* | 309 |
| SH4-14-0450-***_* | 459 |
| SH4-14-0600-***_* | 609 |
| SH4-14-0750-***_* | 759 |
| SH4-14-0900-***_* | 909 |
| SH4-14-1050-***_* | 1059 |
| SH4-14-1200-***_* | 1209 |
| SH4-14-1300-***_* | 1359 |
| SH4-14-1500-***_* | 1509 |
| SH4-14-1650-***_* | 1659 |
| SH4-14-1800-***_* | 1809 |
| SH4-14-1950-***_* | 1959 |
| SH4-14-2100-***_* | 2109 |
| SH4-14-2250-***_* | 2259 |
| | |
| | |
| | |

DIMENSIONS (HAND)

SH30-30-***-**-**_*

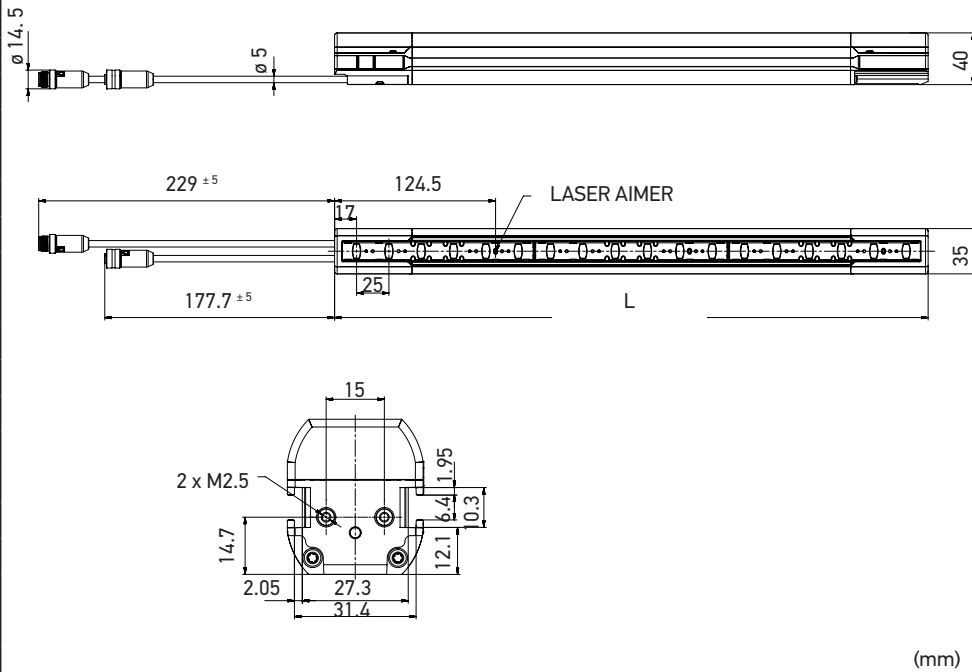

| Model | L (mm) |
|-------------------|--------|
| SH4-30-0300-***_* | 309 |
| SH4-30-0450-***_* | 459 |
| SH4-30-0600-***_* | 609 |
| SH4-30-0750-***_* | 759 |
| SH4-30-0900-***_* | 909 |
| SH4-30-1050-***_* | 1059 |
| SH4-30-1200-***_* | 1209 |
| SH4-30-1300-***_* | 1359 |
| SH4-30-1500-***_* | 1509 |
| SH4-30-1650-***_* | 1659 |
| SH4-30-1800-***_* | 1809 |
| SH4-30-1950-***_* | 1959 |
| SH4-30-2100-***_* | 2109 |
| SH4-30-2250-***_* | 2259 |
| | |
| | |
| | |

DIMENSIONS (BODY)

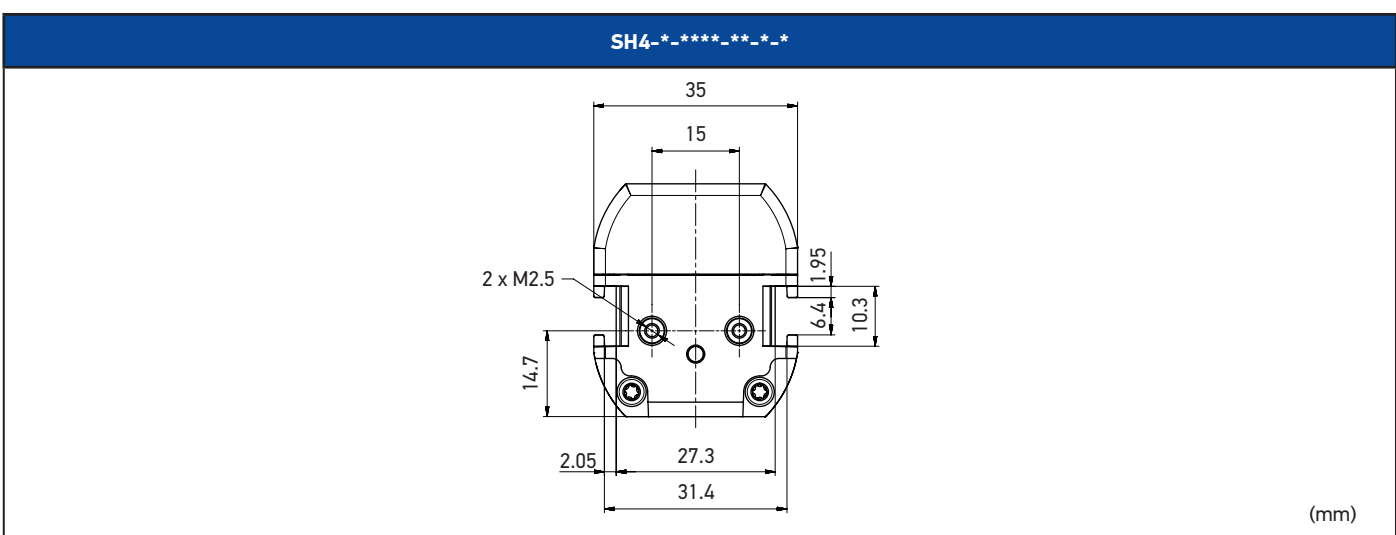
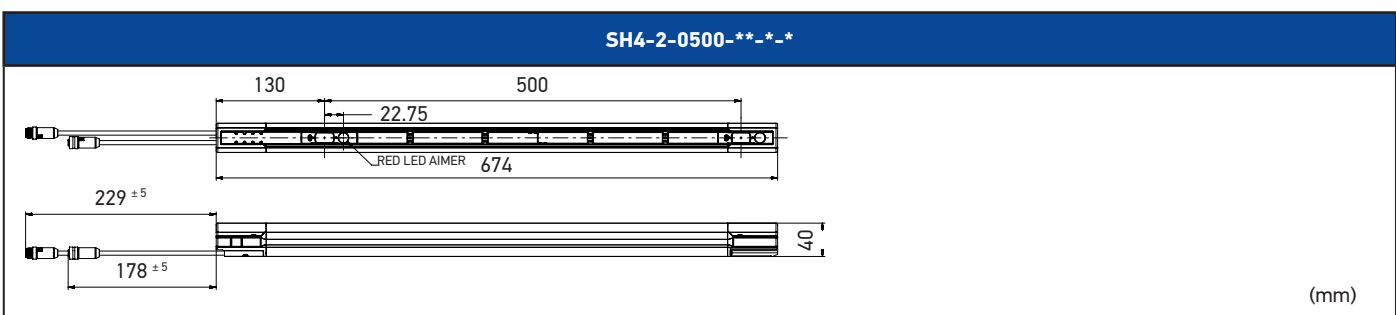
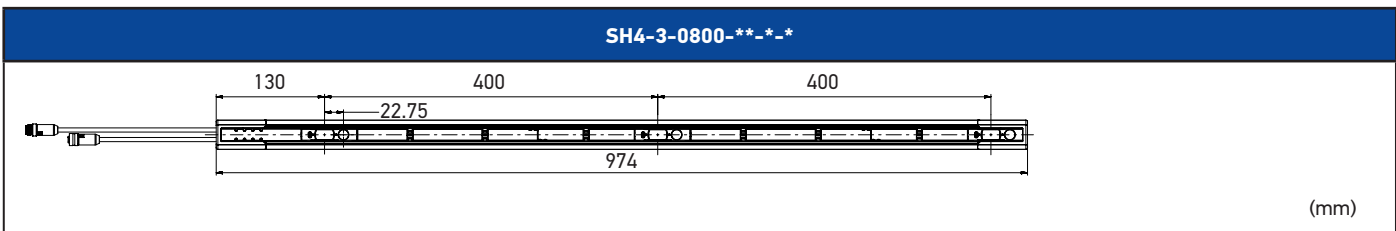
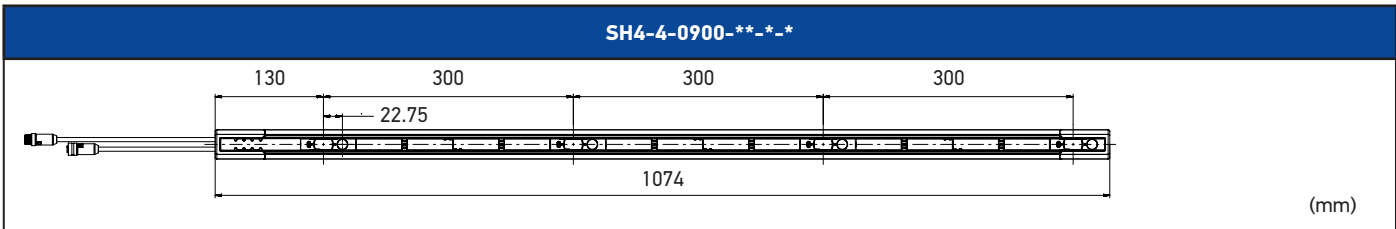
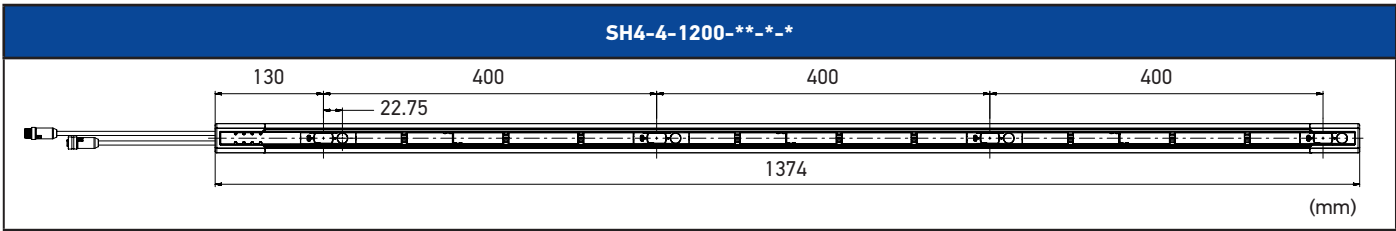

DIMENSIONS (AP)

SH4-*-*-*-*(-AP)-**-*

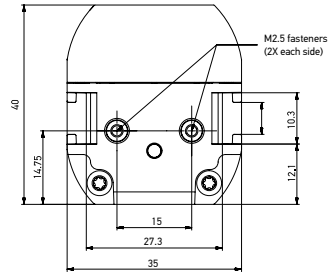
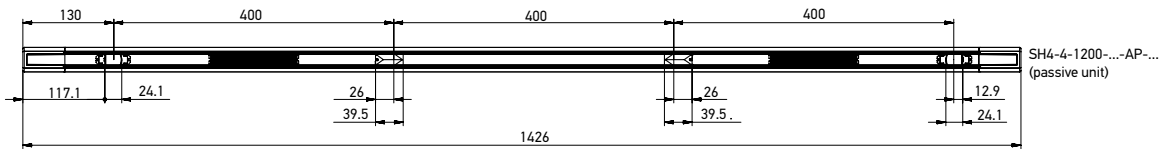
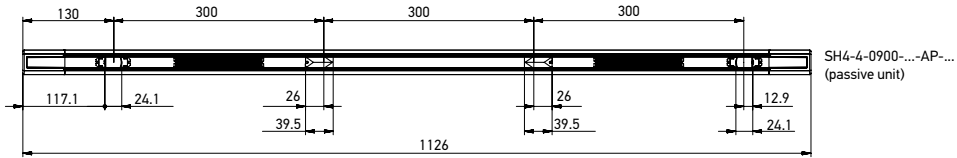
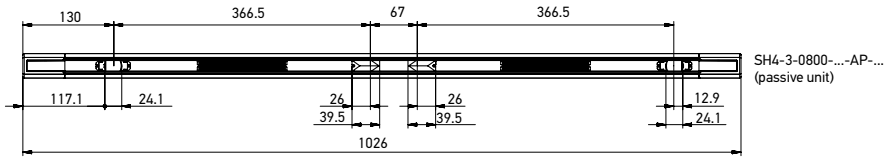
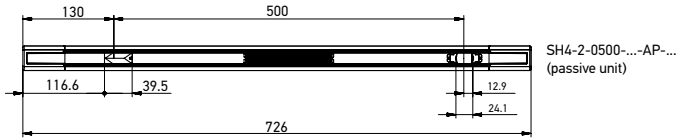
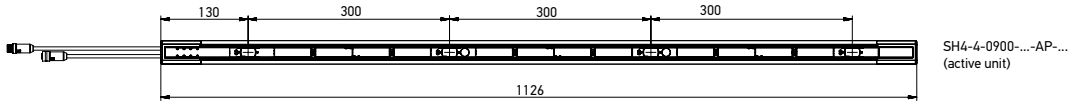
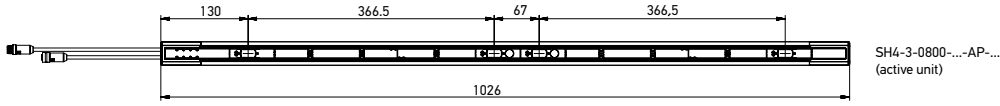
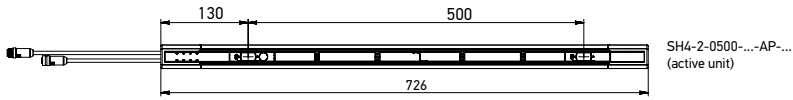

ACCESSORIES: BRACKETS

| ST-K4ROT-SH | | | |
|-------------|---|------------------|------------|
| Model | Order nr. | Compatibility | |
| <p>(mm)</p> | <p>Metal top-bottom rotating fixing brackets kit (4 brackets) for SH4</p> | <p>95ASE0042</p> | <p>SH4</p> |

| ST-KSTD | | | |
|-------------|--|------------------|---|
| Model | Order nr. | Compatibility | Notes |
| <p>(mm)</p> | <p>Metal angled fixing brackets kit (4 brackets) for SH4</p> | <p>95ACC1670</p> | <p>SH4, SG2/SG4, SG BODY COMPACT, SG BODY BIG</p> <p>The angled fixing bracket is included in the package of SH4 but it can be ordered separately for substitutions</p> |

ACCESSORIES: TRANSMITTER AND RECEIVER CABLES

| SH4 BASE (SH4-**-****-B(-AP)-5) | | |
|---|------------|----------------|
| Receiver main connector | Length (m) | Order code |
| CS-A1-03-U-03 | 3 | 95ASE1170 |
| CS-A1-03-U-05 | 5 | 95ASE1180 |
| CS-A1-03-U-10 | 10 | 95ASE1190 |
| CS-A1-03-U-15 | 15 | 95ASE1200 |
| CS-A1-03-U-25 | 25 | 95ASE1210 |
| CS-A1-03-U-50 | 50 | 95A252700 |
| SH4 STANDARD AND SH4 STANDARD MUTING (SH4-**-****-S/SM(-AP)-8(-5)) | | |
| Receiver main connector | Length (m) | Order code |
| CS-A1-06-U-03 | 3 | 95ASE1220 |
| CS-A1-06-U-05 | 5 | 95ASE1230 |
| CS-A1-06-U-10 | 10 | 95ASE1240 |
| CS-A1-06-U-15 | 15 | 95ASE1250 |
| CS-A1-06-U-25 | 25 | 95ASE1260 |
| CS-A1-06-U-50 | 50 | 95A252710 |
| SH4 ADVANCED (SH4-**-****-A(-AP)-12(-5)) | | |
| Receiver main connector | Length (m) | Order code |
| CS-A1-10-U-03 | 3 | 95A252720 |
| CS-A1-10-U-05 | 5 | 95A252730 |
| CS-A1-10-U-10 | 10 | 95A252740 |
| CS-A1-10-U-15 | 15 | 95A252750 |
| CS-A1-10-U-25 | 25 | 95A252760 |
| CS-A1-10-U-50 | 50 | 95A252770 |
| SH4 all models | | |
| Transmitter main connector | Length (m) | Order code |
| CS-A1-03-U-03 | 3 | 95ASE1170 |
| CS-A1-03-U-05 | 5 | 95ASE1180 |
| CS-A1-03-U-10 | 10 | 95ASE1190 |
| CS-A1-03-U-15 | 15 | 95ASE1200 |
| CS-A1-03-U-25 | 25 | 95ASE1210 |
| CS-A1-03-U-50 | 50 | 95A252700 |
| SH4 all Muting models (SH4-**-****-SM/A*-5) | | |
| Receiver/Transmitter secondary connector | Length (m) | Order code |
| CD12M/0B-050B1 | 5 | CD12M/0B-050B1 |
| CD12M/0B-100B1 | 10 | CD12M/0B-100B1 |

ACCESSORIES: CASCADE CABLES

| CS-H2-03-B-** | | |
|---------------|------------|------------|
| | | |
| Model | Length (m) | Order code |
| CS-H2-03-B-01 | 1 m | 95ASE0031 |
| CS-H2-03-B-03 | 3 m | 95ASE0032 |
| CS-H2-03-B-10 | 10 m | 95ASE0033 |

Cascade cables have 5 poles, M12 male connector on one side, and M12 female connector on the opposite side. They can be used to cascade SH4 safety light curtains (refer to manual for technical details)

ACCESSORIES: PLUGS

The following are spare parts that can be ordered in substitution of the parts included in SH4 family safety light curtains.

| SH-PLUG-**-* | | | |
|--------------|-----------------|---------------------|------------|
| | | | |
| (mm) | | | |
| Model | Main connector | Secondary connector | Order code |
| SH-PLUG-5 | 5-pin M12 male | none | 95ASE0047 |
| SH-PLUG-8 | 8-pin M12 male | none | 95ASE0048 |
| SH-PLUG-12 | 12-pin M12 male | none | 95ASE0049 |
| SH-PLUG-5-5 | 5-pin M12 male | 5-pin M12 female | 95ASE0050 |
| SH-PLUG-8-5 | 8-pin M12 male | 5-pin M12 female | 95ASE0051 |
| SH-PLUG-12-5 | 12-pin M12 male | 5-pin M12 female | 95ASE0052 |

ACCESSORIES: SCREW

The following are spare parts that can be ordered in substitution of the parts included in SH4 family safety light curtains.

| SH-SP | | |
|-------|---|------------|
| | | |
| Model | Description | Order code |
| SH-SP | Kit of screw plugs for SH4 female connectors (2 pieces) | 95ASE0043 |

When female secondary connector of SH4 are not used, use a SH-SP plug to isolate them

ACCESSORIES: SH-TARGET

| SH-TARGET | | | |
|-----------|--|------------|--|
| Model | Description | Order code | |
| SH-TARGET | Retroreflector target for SH4 BODY alignment | 95ASE0046 | |

(mm)

ACCESSORIES: M12 MALE-MALE ADAPTER

| SH-MMA | | | |
|--------|-----------------------|------------|--|
| Model | Description | Order code | Notes |
| SH-MMA | M12 Male-Male Adapter | 95ASE0044 | SH-MMA can be used to convert the SH4 secondary connector (M12 female) in a M12 male, in order to reuse SG muting accessories and cables. It is not needed when using muting accessories designed for SH4. |

(mm)

ACCESSORIES: LASER POINTER

| SH-LP | | | |
|-------|-----------------------|------------|---|
| Model | Description | Order code | Notes |
| SH-LP | Laser pointer class 2 | 95ASE0030 | SH-LP is a laser pointer with a plastic bracket that can be quickly connected to the profile of SH4 safety light curtains in order to ease the alignment of transmitter and receiver. |

(mm)

ACCESSORIES: MUTING ARMS FOR 2-SIGNALS T AND L MUTING

SH-T-ARMS and SH-L-ARMS are ready to install kits composed of:

1. active arm, with retroreflective polarized photocells: 1 for SH-L-ARMS, 2 for SH-T-ARMS
2. passive arm, with corresponding reflectors: 1 for SH-L-ARMS, 2 for SH-T-ARMS
3. 2 brackets to connect arms to SH4
4. 1 muting cable CV-Y4-02-B-007 (for SH-T -ARMS) or CV-L2-02-B-007 (for SH-L-ARMS) to connect the active arms to the secondary 5-poles connector of SH4 STANDARD MUTING, or SH4 ADVANCED.

SH-T/L-ARMS

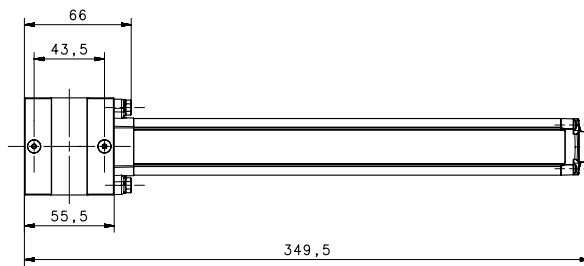
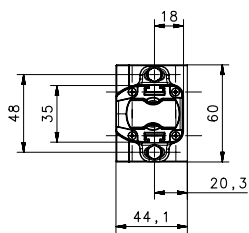
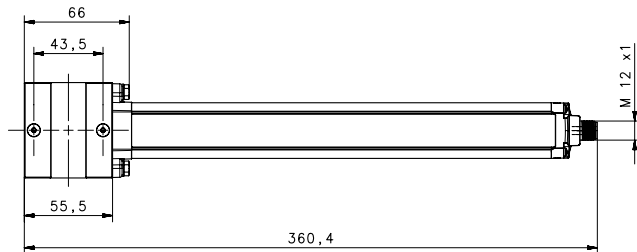
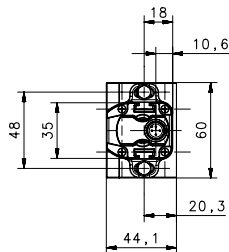
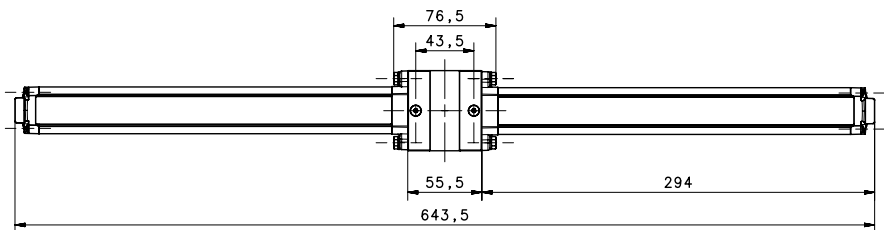
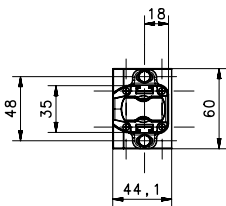
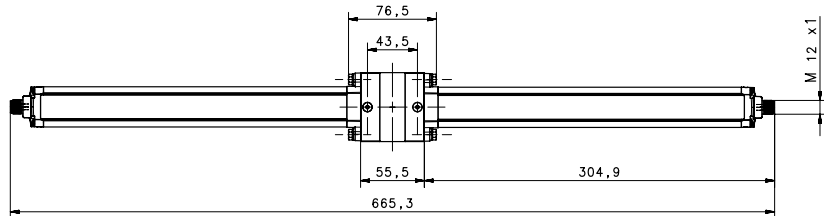
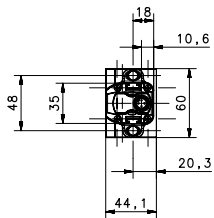

| Model | Description | Order number |
|-----------|---|--------------|
| SH-T-ARMS | Active/Passive arms Couple for T muting | 95ASE0035 |
| SH-L-ARMS | Active/Passive arms Couple for L muting | 95ASE0036 |

IMPORTANT NOTICE: For safety reasons, L muting arms should be used only for openings through which goods must exit from the dangerous area: for openings in which goods must enter the dangerous area, as well as for bi-directional movements, use T muting arms.

ACCESSORIES: CABLES FOR MUTING ACTUATORS

CV-**-02-B-007

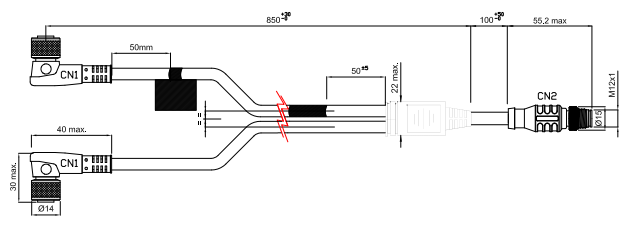
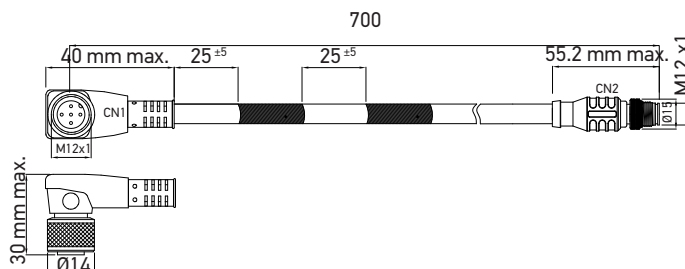
| | Model | Description | Order code |
|--|----------------|------------------------------------|------------|
|  | CV-Y4-02-B-007 | M12 4-poles T muting cable for SH4 | 95ASE0037 |
|  <p>(mm)</p> | CV-L2-02-B-007 | M12 4-poles L muting cable for SH4 | 95ASE0038 |

ACCESSORIES: SH MUTING CONNECTION BOX

SH-M-CB

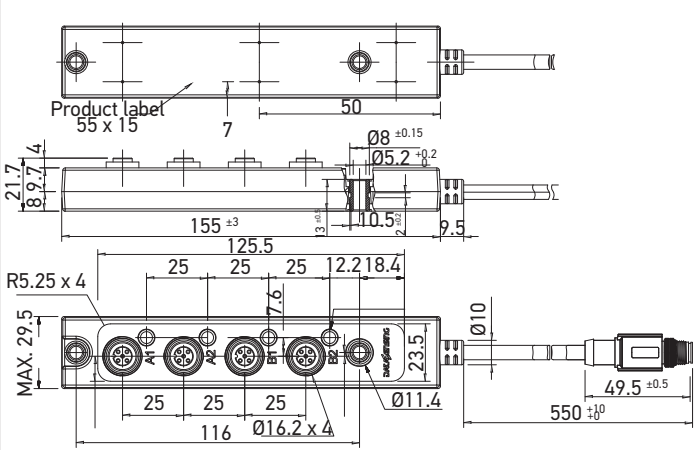
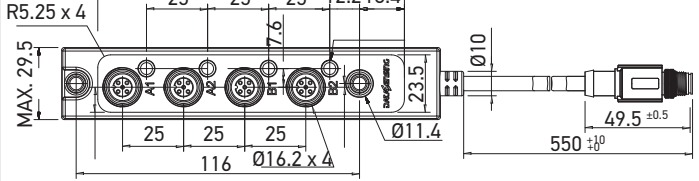
| | Model | Description | Order code |
|---|-------------|---------------------------|------------|
|  | SH-M-CB | SH Muting connection box | 95ASE0039 |
|  <p>(mm)</p> | SG-M-CB-KIT | Muting connection box kit | 95ASE2830 |

The SH-M-CB connection box has 4 M12 connectors on board, one for each muting sensor to be connected to an SH4 light curtain. Unused connectors need to be covered by a cap, in order to maintain IP67 protection. A green LED indicator signals when the muting sensor is generating the corresponding muting signal towards the safety light curtain. Inside the connection box, signals are put in parallel: A1 with A2 and B1 with B2, and forwarded to the pigtail connector, that has to be inserted into the muting connector of the light curtain. This means that muting function of SH4 for which SH-M-CB is compatible are 2-signals T muting and 2-signals L muting. In order to attach SH-M-CB to the housing grooves of SH-M-CB, order SG-M-CB-KIT.